

## Model BLD Series

Large Display

### BLD-235/236

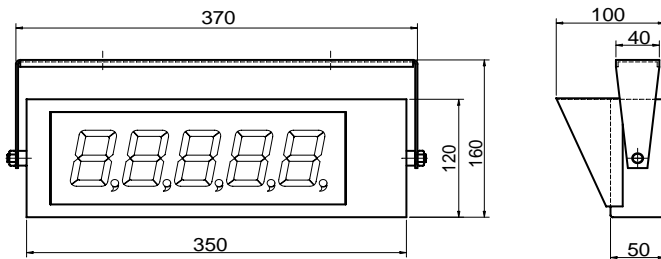

**For:**

-Digital Indicator

**Features:**

- High brightness.
- Uniform brightness and wide angle viewing.
- Solid state stability and long operation life.

### SPECIFICATIONS

| Model               | BLD-235  | BLD-236  |
|---------------------|--|----------|
| 1.Display           | High brightness 2.3-inch 7-segment numeric LED display |          |
| 2.Digit             | 5 Digits   | 6 Digits |
| 3.Size of digit     | 56.9 mm High   |          |
| 4.LED color         | Red  |          |
| 5.Interface         | RS-232C, RS-422/485                                    |          |
| 6.Operating temp    | Temp.: -10 ~60 °C                                      |          |
| 7.Power supply      | AC 110/220V, 1PH, 50/60 Hz or dc 12/24V                |          |
| 8.Power consumption | Appr. 2VA  |          |

### BLD-405

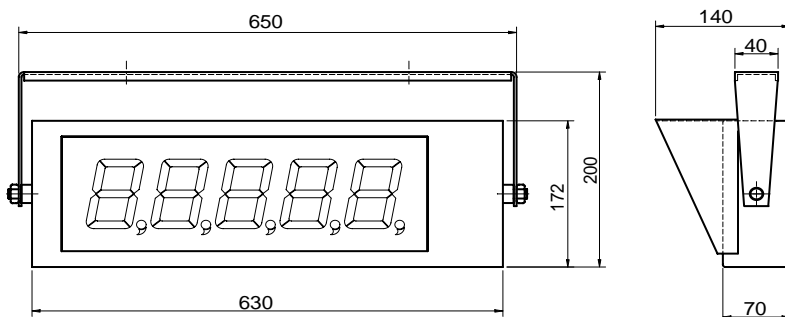

**For:**

-Digital Indicator

**Features:**

- High brightness.
- Uniform brightness and wide angle viewing.
- Solid state stability and long operation life.

### SPECIFICATIONS

| Model               | BLD-405  |
|---------------------|--|
| 1.Display           | High brightness 4-inch 7-segment numeric LED display |
| 2.Digit             | 5 Digits   |
| 3.Size of digit     | 100 mm High  |
| 4.LED color         | Red  |
| 5.Interface         | RS-232C, RS-422/485                                  |
| 6.Operating temp    | Temp.: -10 ~60 °C                                    |
| 7.Power supply      | AC 110/220V, 1PH, 50/60 Hz or dc 12/24V              |
| 8.Power consumption | Appr. 3VA  |

\* Specifications are subject to change without notice

OCT.2000